

AGRICULTURE

FORM FOUR

APRIL HOLIDAY ASSIGNMENT - 2024

1. Describe the field production of maize under the following sub headings

- a) Ecological requirement
- b) Varieties
- c) Seedbed preparation
- d) Pests and diseases
- e) Harvesting

2. Explain **five** cultural methods of pest control in stored grains

3. Study the illustrations given below and then answer the questions that follow: -



- (a) Identify the pests shown by the illustrations **B and C**
- (b) State **one** effective method of controlling the pest labelled
- (c) Name the type of crop commonly attacked by the pest labelled '**C**'

4. List **four** factors that determine the quality of hay

5. Explain Napier grass production under the following sub-headings

- i) Seedbed preparation
- ii) Planting
- iii) Fertilizer application
- iv) Weed control
- v) Utilization

6. The diagram below shows a fungal disease in a section of potato crop leaf

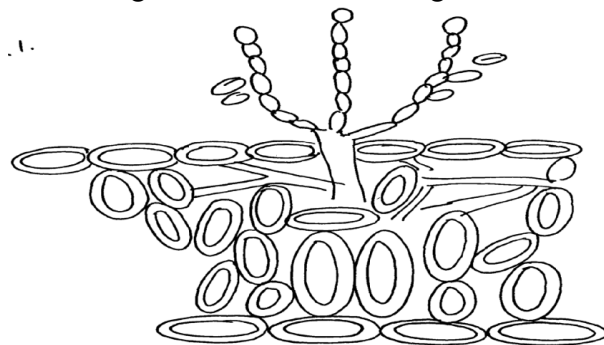

- a) Identify the fungal disease

b) (i) State the causal organism of the disease identified above

ii) Give **two** symptoms of the above disease

c) Give **two** control measures of the disease

7. Name **two** diseases that affect female animals only

8. Give **four** pre disposing factors of foot rot disease in sheep

9. (a) Discuss **coccidiosis** disease under the following headings: -

(i) Causal organism

(ii) Livestock species attacked

(iii) Symptoms of attack

(iv) Control measures

10. State **four** predisposing factors of scour in calves

11. Name **four** notifiable diseases of livestock

12. Name **two** diseases of poultry that are controlled by vaccination

13. State **three** signs of anthrax injection disease observed in the carcass of a cattle

14. List **three** causes of ruminal tympany (Bloat) in ruminant animals

15. (a) Give **four** symptoms of milk fever

(b) State **two** methods of controlling milk fever

16. The diagram below is part of a farm structure. Study it and then answer the questions that follow

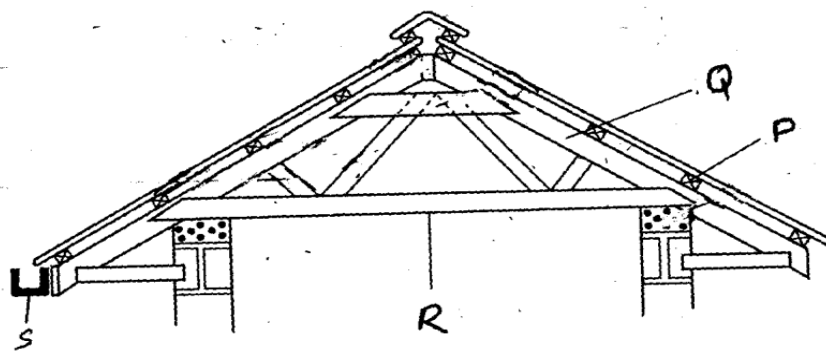

(a) Name part of structure represented above

(b) Identify parts labeled **P**, **Q**, **R**, and **S**

(c) Give the functions of the part labeled **P** and **S**

17. List **four** uses of crush in the farm

18. a) Define the term **fence**

b) List various types of fences

c) Describe advantages of fences